

How to Handle a SAK Leak into the PureFlow Drawer

NOTE: These tips were put together by a dialysis nurse. The Medical Education Institute and Home Dialysis Central are not responsible for its content or accuracy. Please have it reviewed by YOUR care team before use.



Step #1: Identify that there is fluid in the drawer outside of the SAK. Understand that you cannot use this SAK...but you do NOT have to bail it out like a sinking rowboat!

See the water in there?

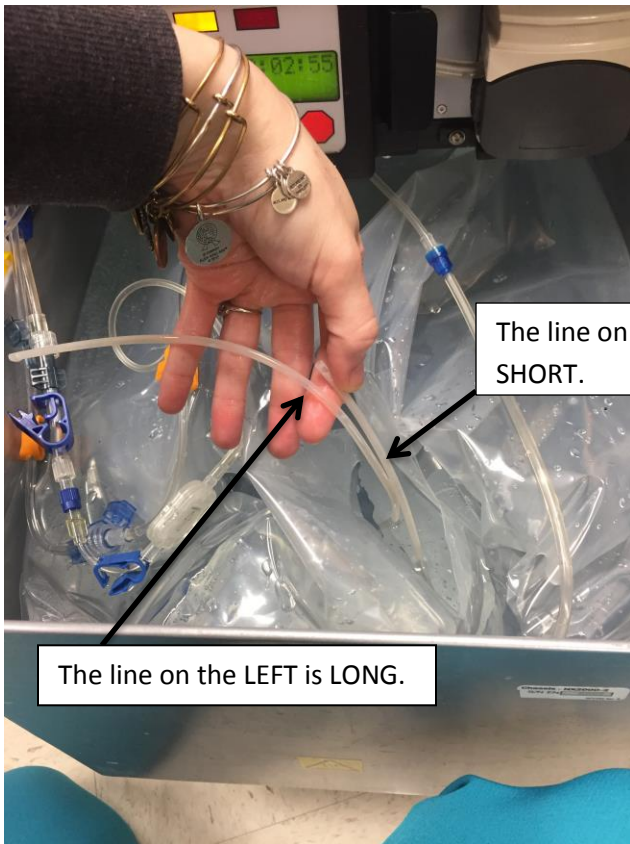

The line on the RIGHT is SHORT.

The line on the LEFT is LONG.

Step #2: Using a pair of scissors, CUT OPEN THE SAK. Reach your hand inside and PULL OUT the two "straws" that are inside the SAK. This is how fluid usually moves in and out of the SAK.

...continue to the PAGE TWO for more...

Step #3: If you are able, CLAMP the “straw” on the LEFT. This will allow everything to drain faster. You can use hemostats, a binder clip, or a hair barrette for this.

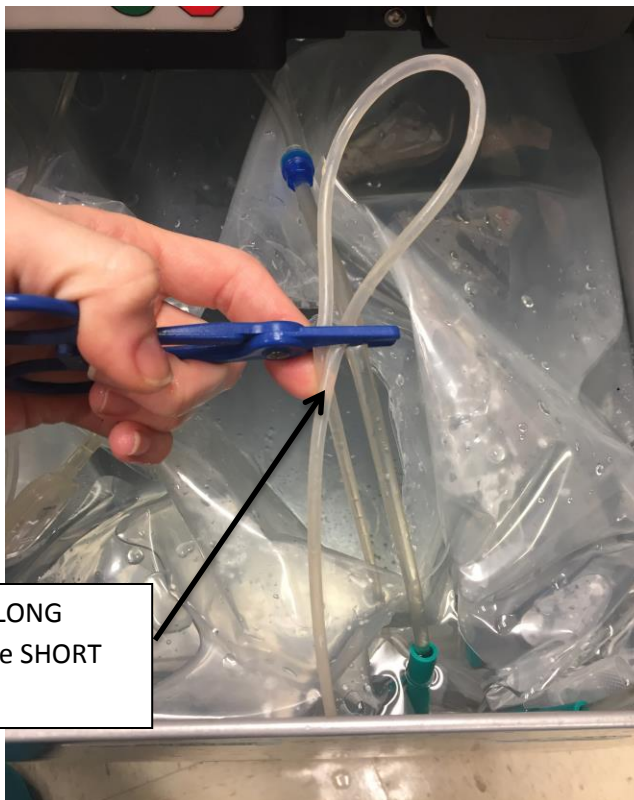

Remember: you are clamping the LONG “straw”. You ARE NOT clamping the SHORT one!

Step #4: Use your scissors to cut the SHORT line OUT of the BAG. It will look like this once it is FREE. →

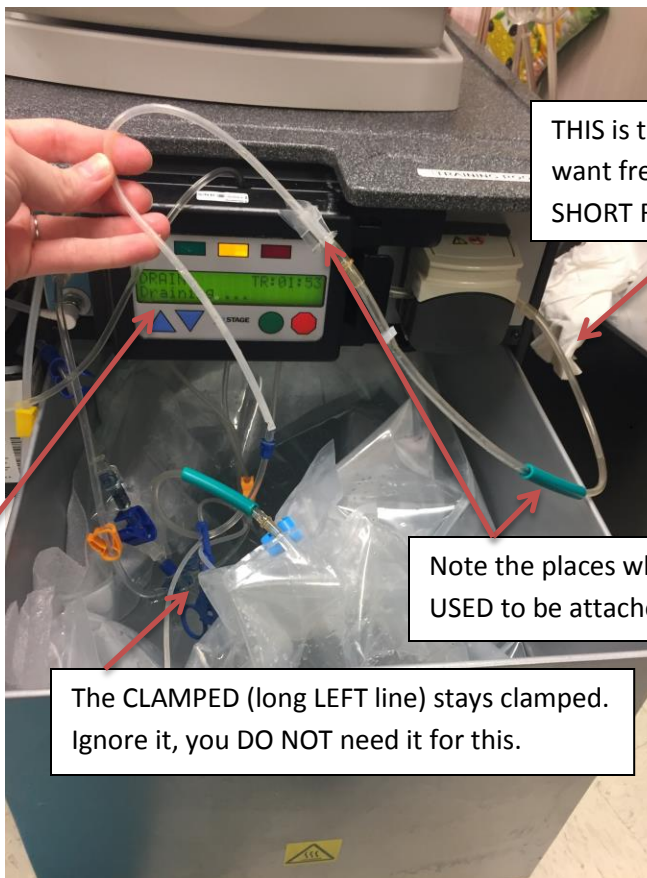

THIS is the “Straw” you want free. This was the SHORT RIGHT line.

Step #5: Tell your PureFlow machine to DRAIN! It will use the “straw” to drain all of the fluid out of the drawer. The machine has NO IDEA that you have cut the SAK open to make this possible!

Note the places where this line USED to be attached to the SAK.

The CLAMPED (long LEFT line) stays clamped. Ignore it, you DO NOT need it for this.

...continue to the PAGE THREE for more...

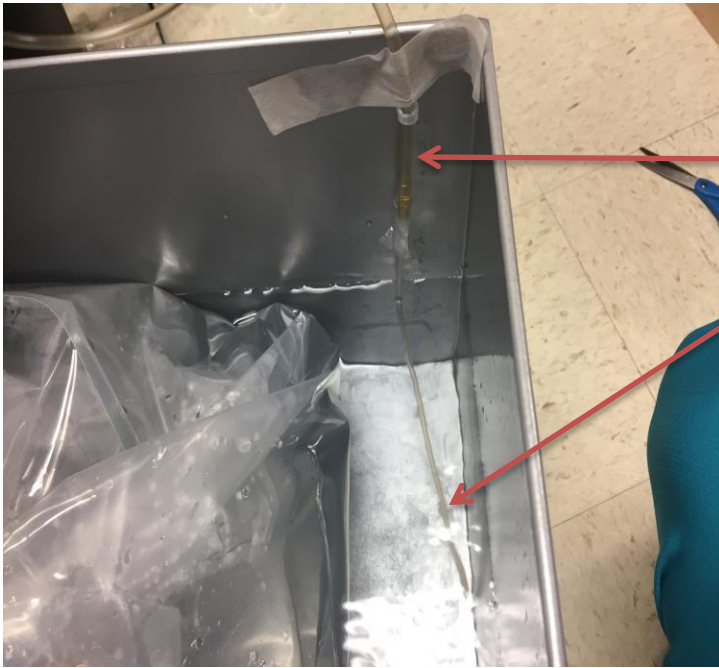

Step #6: Place your free line INTO the free-fluid inside of the drawer to allow it to DRAIN. It's a good idea to TAPE it down so it stays submerged.



Step #7: Attempt to wait patiently for the drain to finish. Consider singing a song, hanging some bags, jumping rope, or doing a long crossword puzzle while you wait. 😊



Step #8: Once it is MOSTLY DRY, remove the plastic of the SAK and allow for the rest of it to drain.

Here is the line doing the draining!

Here is the SAK outside of the drawer.

LOOK! It is ALMOST empty!

Steps #9 & #10: When drain is complete, remove SAK and lines. Discard. Then, DRY the inside of the drawer with a towel until the machine sensors no longer detect fluid and the screen returns to "STANDBY: NO BATCH". Ta-da!